

TUTBURY PARISH COUNCIL (TPC)

An Emergency Committee meeting of the Parish Council was held on site at Chatsworth Drive and afterwards in Tutbury Village Hall, Monk Street, Tutbury Monday 22nd May 2017.

Those present were Cllrs C Smedley (Chairman), Councillor, S Adams, F Crossley, L Beighton, residents of Ironwalls Lane, in attendance, Karen Duffill (Clerk)

220517/1.0 APOLOGIES

1.1 Apologies received from, Parish Councillors, M Guest (Vice Chair), J Hale, P Steadman.

Declaration of interest and apologies received from Cllr D Morris.

220517/2.0 TO DECIDE ON THE BOUNDARY FENCE OF THE PARK PALE FOOTPATH OFF CHATSWORTH DRIVE.

The Emergency Committee met with the residents of Ironwalls lane who own the fence bordering the land maintained by the Parish Council and their property. The area of land is in front of the existing fence.

The boundary line plan has been provided by land registry see appendix 1.

The clerk has received some quotes regarding replacing the existing fence further down the bank towards the boundary line. However, the type of fence recommended by the contractors differed from the specification previously written and agreed.

Cllrs and the residents agreed that the best place for the fence would be on the boundary that has now been confirmed. The height of this fence will need to be within 2 metres high due to its position on a public footpath. Any higher and planning permission is required.

A new fence placed on the boundary would mean that the area that was previously maintained by the parish council would now be maintained by the owners of Ironwalls Lane The land is part of the ancient monument and should not be disturbed and the grass strimmed not mown.

It was resolved that a new specification would be written and three new quotes would be obtained for a closed boarded feather edge fence more suitable to be erected to follow the curve of the boundary. 8ft concrete posts would be required. The residents agreed to pay half of the cost of the fence and maintain it.

RESOLUTION

Three new quotes will be submitted at the next council meeting, for approval with the council and the residents, before work could commence. A purchase order will need to be signed by the residents as they will be contributing to half of the cost.

220517/3.0 TO REVIEW STREET CLEANING TENDER

3.1 Two tender bids have been received one stated the number of hours per week the contract would entail and one did not. Cllrs agreed that the tender invitation was too ambiguous resulting in the tenders not matching what the council were looking for and were not easily comparable. Cllr F Crossley proposed that the tender was re advertised stipulating the number of hours and days of the week that the work required.

RESOLUTION.

The clerk will produce a new tender invitation stating seven hours a week to be carried out on a Monday and Friday. Additional hours maybe required for other areas of the village and an hourly rate should be submitted. The contract should be for six months initially and reviewed with the budget in December. The deadline for the new advertisement would be 12th June and a notice would be placed on the notice board and posted on social media.

3.2 The requirement to keep the bus shelters, streets and phone box weed free was discussed. The clerk stated that the Borough Council spray the streets twice a year, but it was thought that this should be done more regularly. The clerk may be able to instruct existing contractors to carry this out this work, if the contractors tender did not hold the qualification to be able to do this. A manual approach would be expected to keep designated areas weed free.

RESOLUTION

To instruct local or existing contractor to weed spray the streets and strim close bank if no suitable tender bid was not secured.

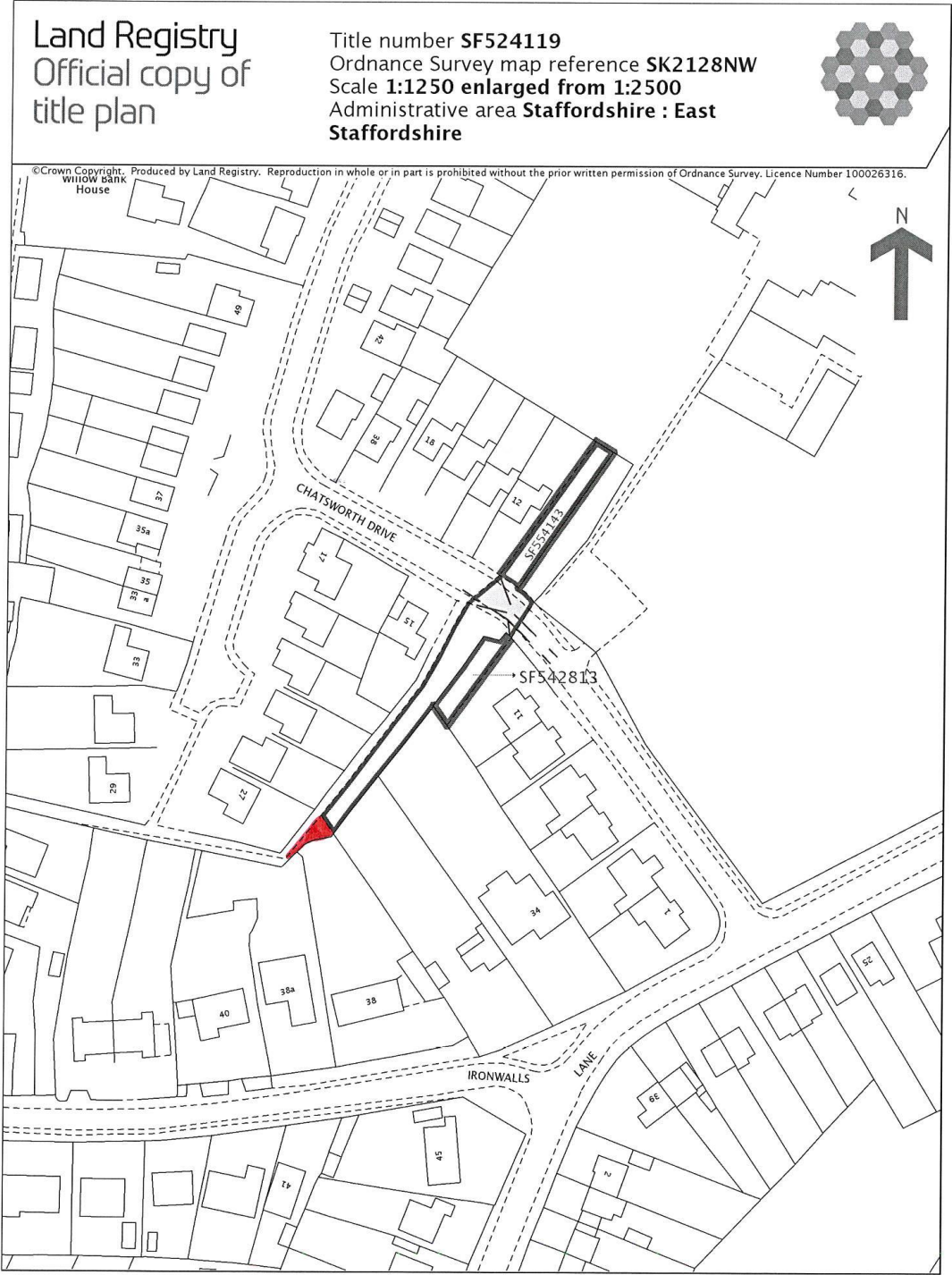

This official copy is incomplete without the preceding notes page.

Appendix 2

TUTBURY PARISH COUNCIL

Clerk:
Karen Duffill

9 PINFOLD CLOSE
TUTBURY
BURTON UPON TRENT
STAFFORDSHIRE
clerk@tutbury.staffslc.gov.uk

Telephone
07486 406045

Tutbury Parish Council

Boundary fence to the rear of 38 Ironwalls lane. Specification of work to form the correct boundary line between the rear of 38a Ironwalls lane and the park pale.

General. The specification of the fence to be erected in front of the existing fence panels is designed to keep any excavation into the park pale to a minimum. Note the existing fence panels are to remain.

The security of the garden must be maintained at all times and the public footpath to be closed to passers-by during the works.

Specification

- Remove 2 tree stumps situated in front of the existing fence panels.
- Excavate to receive 5 8ft (2440 mm) concrete posts from top left corner post at existing panel, sweeping down to adjacent with the bottom existing panel. Note: Concrete posts are to be set at equal centres and each set 2" (600mm) into the ground.
- 4x2 rough sawn timbers to be bolted to each concrete support and to be set above ground level at each point.
- 3 cross rails to be fixed along the run following the gradient of the ground.
- Feather edge boarding to be fixed to the cross rails and following the gradient of the ground. All boarding to be kept 2" (50 mm) from the ground level through the entirety of the run. Note: Tops of the boards are to follow the gradient from the top of the corner post at top panel down to the top of the corner post adjacent to the public footpath.
- All debris to be removed from site before footpath is reopened to the public.
- All feather edge boarding to overlap by 25mm.

F Crossley.